

TPM-5 Quick Start Guide

Diagnostic Tool

Important

Please read this manual before using TPM-5. Diagnosing software has not been installed yet. Start diagnosing after registering and updating.

Warning

- If Diagnosing icon is not displayed on the main menu, the software has not been installed. Please diagnose with the newest version after registering and updating. (Figure 1)
- Please use TPM updating program with Window 7 or newer.
- If the TPM update software is deleted by security software, Please download from "http://www.scantool.jp/downloads/tpm/tpm.exe" and save it in the main unit.

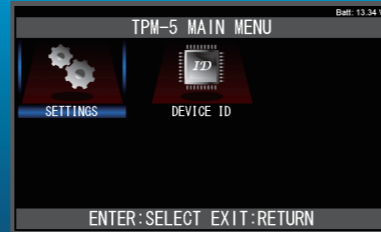

(Figure 1)

TPM-5 Packing list

Please make sure that this product package includes the following.

TPM-5 base unit	OBD-II cable	Cigar cable	microUSB cable
Carrying case	Quick start guide		

Warning These items are subject to change without any notices.

Downloading the instruction manual

You can download the instruction manual with PDF file.

Step1

[TPM update] in start-up state, please click [Download user manual]

Step2

Downloading manual will start.

Step3

When the download is complete, please save the file as you wish.

Step4

There is a file which you saved (From Step 3). Please double click and open the file.

Warning If you can not save the file, please try to change the location. If you can not see the file well, please use the latest version of Adobe(R)READER(R).

User registration

Step1

Connect the TPM-5 base unit to computer with the included microUSB cable. The illustration of the USB cable is displayed on the base unit screen and the PC connection mode is set.

Step2

When PC recognized TPM-5, auto play menu will display. And click open folder to view files. If auto play menu will not displayed, simply choose [Explorer]-[PC]-[Removable disk]and run [tpm.exe].

Step3

[TPM update] screen is on, please click [Change user info]. Please go to the next section after reading and understanding the privacy policy.

Step4

[User registration] screen is on, please fill out all boxes and click [Send].

Step5

After sending information, this message comes and please check your email box.

Step6

Please check your email. You should have email [scantool.jp registration email] from [admin@scantool.jp]. Please click the link

Step7

After clicking the link, the serial number of your base unit and the valid date appears. (It is one year free updating since your registration date)

Warning Due to your security software, it may block communication. In that case, you will need changing setting of your security software. In case, you do not receive email, possibility of wrong email address or checking junk emails. When the valid date is not showing on authentication screen, please check the registration email once more. You are supposed to get emails as many as you click the link so check the latest one you have received.

Update

Connecting Base unit: Please check User registration Step 1 and Step 2

Step1

Please click [Start update] on [TPM update] screen.

Step2

It will download and write into base unit.

Step3

When "Update complete" is displayed, click [OK] to exit the application. This completes the update.

Warning If the "Unable to write" error is displayed when you start the update, check the security software settings. Also, run it with an administrator account.

Parts name

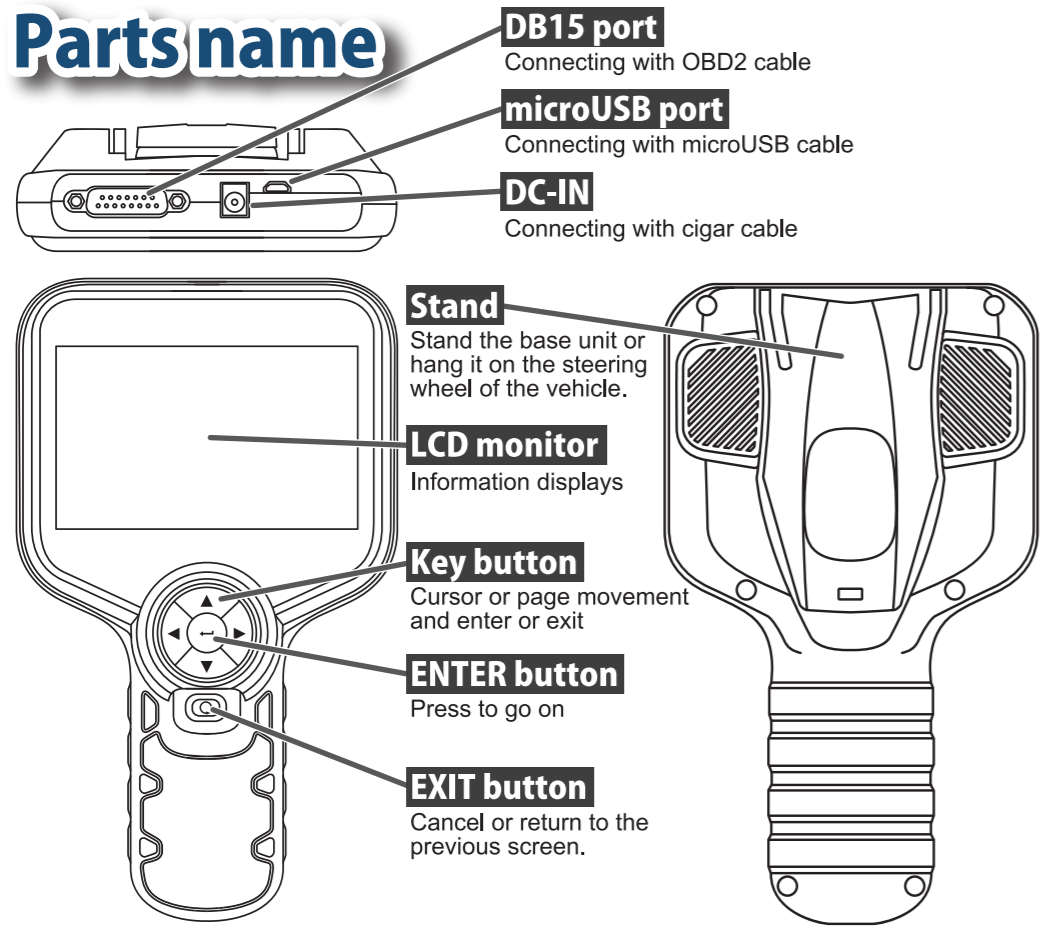

How to Diagnosis

How to diagnosis is the following
Please diagnose the vehicle with ignition key ON state.

Step1

Please make sure your vehicle ignition is "OFF". And connect TPM-5 to DLC, then turn ignition key "ON".

Ignition OFF → Ignition ON

Step2

TPM-5 main menu displays. Please select [SCAN] and [Enter].

Step3

Please select Domestic vehicle, Import, Truck or OBD and choose the car manufacture.

Step4

[Vehicle select] : [Autodetect] or [Manual selection] and [Enter]

※It depends on the car manufacture.

Step5

[Vehicle select]: [Brand] [Vehicle name] [Vehicle type] [Engine type] [Option]

※It depends on the car manufacture.

Step6

[Main menu] displays. Please choose your demanding item and [Enter].

Step7

Selecting which you diagnose and push [Enter]. This sample screen is selected [Short Test].

Step8

[Short Test] checks all systems that the vehicle carries.

Warning Please check the connector connection or ignition key ON when you have trouble with diagnosing.

Screen description

Scan
Diagnose.

Save data
Display the saved DTC and datastream.

Settings
Set the language, date, etc.

Special functions
These special functions are included maintenance mode, DPF generation, Aiming and Battery test.

OBDII
Diagnosis with global OBD2 software.

Device ID
Serial number and valid date display.

Selecting cursor
When you select item, the characters are highlighted.

Number of DTC's
DTC numbers display

Title
Present system or message displays.

Scroll bar
This displays when there are many diagnosing numbers.

Diagnosis trouble code
DTC displays with P,B,C,U plus 4 digits.

DTC description

Page numbers
Page numbers display. The page changes with direction (up & down) key.

Data save&print
You can select [Data save] to save into Base unit or [Print] to print with direct printer.

Diagnosing result: Display, Print, Save & Erase

After result of diagnosing the vehicle, your steps are the following.
Please erase DTC when the vehicle's ignition key ON. If engine runs, some DTC's can not clear.

Review

Review shows whether there are any DTC's or not. Please select ECU and push [Enter] so you may check individual ECU and DTC.

Print

[Print] and press [Enter] to print your result of diagnosing. Please turn on TPM-5 exclusive use printer before pressing [Enter] key.

※Requires an optional Bluetooth mini printer.

Data save

[Save] and press [Enter] can save your selecting data. You may find saving data file on [Reports] folder in base unit. Due to memory size of the files, it may not be able to save the data so please send the data to your PC every time.

Clear All

[Clear All] and press [Enter] to erase all trouble codes. TPM-5 will erase all ECU code. When it is done, you see all ECU have been erased by looking the screen. When the trouble is there, existing, the code will not be able to erase without fixing. Please try to erase the code after repair the trouble.

Warning When you wish to finish diagnosing, please press [Exit] until [Maker select] and ignition OFF, disconnect TPM-5 from the vehicle connector.